

## Motor-Driven Hydraulic Press

Model 164



Manufactured for Swade-Sir in Italy

Model No.154/ML - 10 Tonne  
 Model No.156/ML - 20 Tonne  
 Model No.P30/ML - 30 Tonne  
 Model No.161 - 40 Tonne  
 Model No.162 - 50 Tonne  
 Model No.163 - 70 Tonne  
 Model No.164 - 100 Tonne

- Motor-driven Hydraulic presses (three-phase 230/400-50 Hz) with high pressure pump, and pressure gauge & double acting cylinder.
- Fitted with a calibration valve and a three-position valve (feed-neutral-return).
- All the machines are complete with oil.
- These models are also equipped with winch for the hoisting of the working-table (model 154/ML and 156/ML excepted).
- Shafts are in treated and chromium-plated special steel.

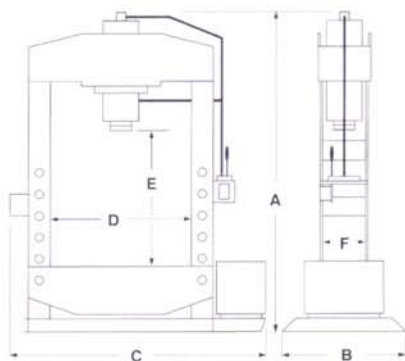

### Specifications



Model	154/ML	156/ML	P30/ML	161	162	163	164
Capacity	10 Tonne	20 Tonne	30 Tonne	40 Tonne	50 Tonne	70 Tonne	100 Tonne
Dimension A (mm)	1900	1920	2000	2070	2080	2205	2260
Dimension B (mm)	500	500	600	850	850	900	900
Dimension C (mm)	1100	1110	1600	1575	1570	1755	1930
Dimension D (mm)	510	505	700	775	775	880	1010
Dimension E (mm)	930	920	1000	1135	1135	1120	1055
Dimension F (mm)	140	140	180	195	205	265	280
Ram Stroke (mm)	260	285	260	260	260	310	310
Pump Capacity							
Lt/Min	1.6	1.6	2.4	2.4	2.4	4.5	4.5
Rod Speed (mm/Minute)	570	420	300	300	210	260	180
Weight (kg)	174	190	320	440	480	740	1000

Swadesir International Pty Ltd.

5-7 Strong Avenue, Thomastown, 3074

Phone: (03) 9460 3444 Fax: (03) 9460 8777

www.swadesir.com.au Email: infosupport@swadesir.com.au